

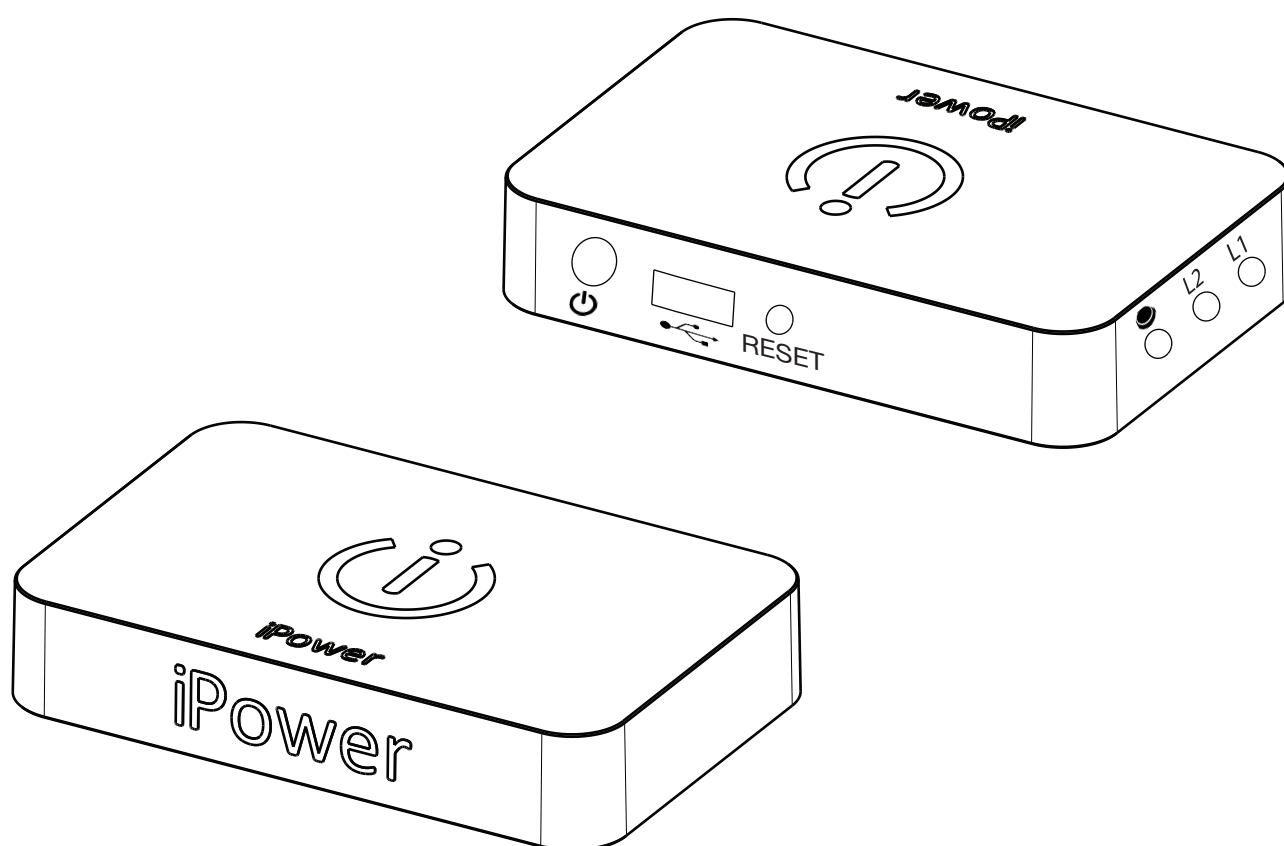

User Manual



Index.....	2
DocumentHistory.	3
Intended Use.....	3
General Information	3
Manual Creation	3
Description	4
Package Contents.....	4
Instructions.	5
Initial Start-up	5
Control Application	6
Specifications	7
External Power Supply	7
iPower Main Unit.....	7
Certification	7
Identification Label.....	7
CE certification	8
FCC certification	9
Safety Rules.....	10
Policy	10
Product.....	10
Clients.....	10
QR code Applications	11

DATE(DD-MM-YY)	MODIFICATIONS	REVISION
10-11-2014	First Version	1.0
26-02-2015	Certification added	1.1

Intended use

The iPower device is designed to provide power supply for coil or rotary tattoo machines used by professional tattoo artists.

General Information

It is important to keep this informative document together with the iPower device, for the entire lifetime of the purchased machine. In the instance it were to be given to a third party or to different users, the manual must be handed over together with the iPower device. The information contained in the manual may be subject to change without prior notice. The iPowercompany s.r.l. assumes no responsibility for mistakes in this documentation.

Manual Creation

This manual was created by the iPower s.r.l., and it was originally written in Italian.

Description



The iPower device is a double output power supply controlled by USB connection. The control of the power supply can only be achieved through Android devices 4.3 or higher, equipped with BLE (Bluetooth Low Energy) technology, and iPhone 4S or higher. The power supply's double output allows connecting two coil or rotary tattoo machines at the same time, and using the control application it's possible to choose which one to use and change its output voltage.

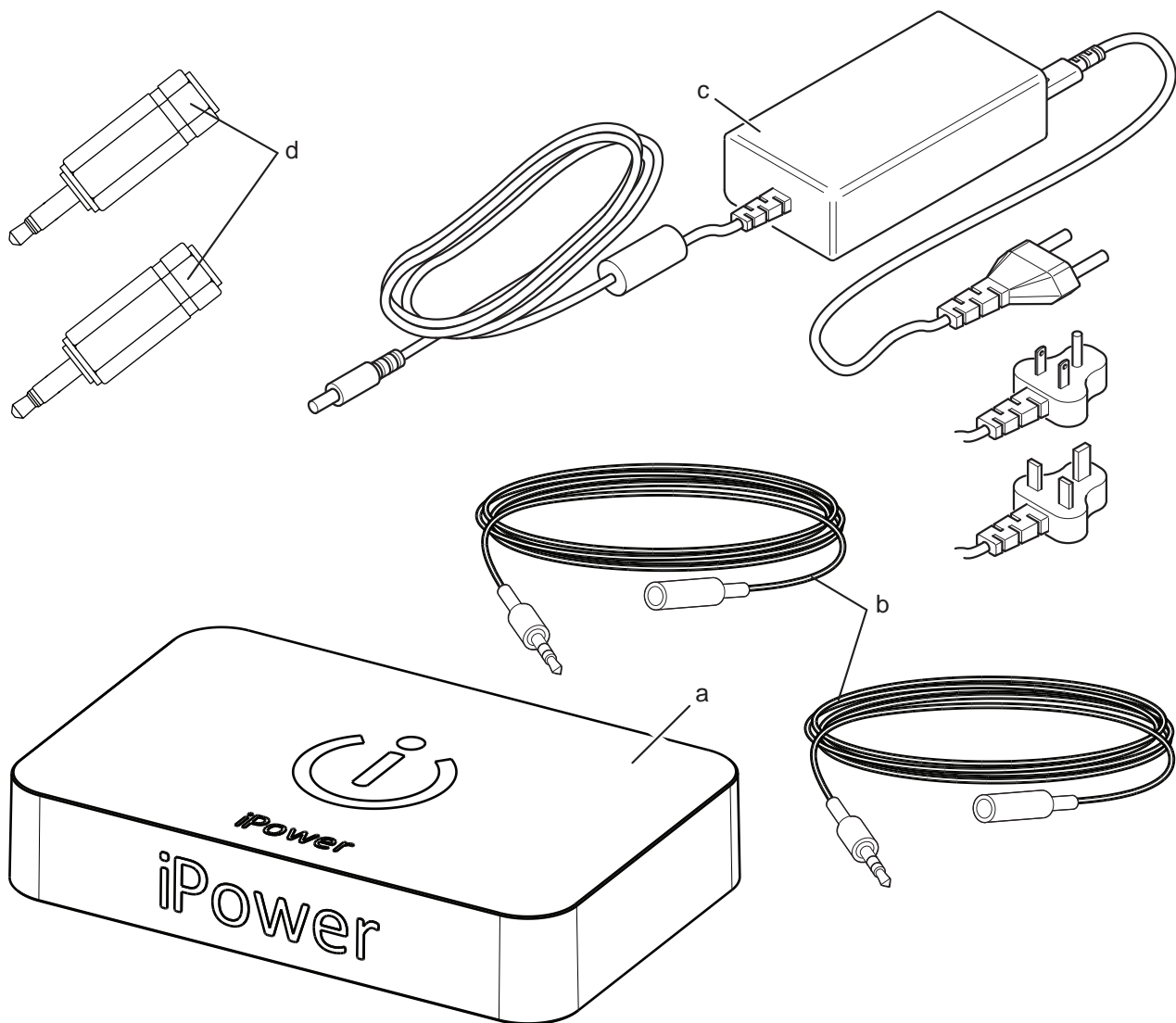



Package Contents:

- | | | | |
|----|------------------------|----|--|
| a. | Main Unit | c. | Power Supply (it differs depending on the Country) |
| b. | Connecting Cables (X2) | d. | Jack adapters from 3,5mm to 6,3mm (X2) |

Make sure that the inside of the package doesn't show any external damage and that all the material is included.

Initial Start-Up

1. Place the device on a clean surface.
2. Connect the external power supply to a power outlet and to the iPower device. If correctly powered, the device will show a continuous blue light.
3. Connect the cables that will provide voltage from the iPower device to the machine (L1-L2 outputs) and then connect the third output to the pedal, in case you intend to use one.
4. Download the control application "iPower" from the Play Store (Android devices) or from the AppleStore (Apple devices).
5. After installing the application, don't launch it before having made sure you have enabled the Bluetooth function.
6. After launching the application, go to "Password and Card Name" from the menu and set a default password selecting "Set Password". The default password is: tattoo.
7. Go back to the initial screen and connect the device tapping on the "CONNECT" button with the symbol  on it. Depending on the device you're using, you may be asked to connect the Bluetooth device, in this case you should select "BLE_SHIELDXXXX". Note: we strongly suggest to set a new password right after entering the default one; this will avoid the risk of conflict between devices.
8. After completing these operations, select the desired pedal mode in the pedal entry you can reach from the menu; the possible modes are: "Pedal on/off" (hold and release to run, hold and release again to stop), "Continued Pedal" (hold to run, release to stop), "Remote Pedal" (it excludes the external pedal and activates the screen pedal, marked by the symbol .
9. Using the buttons "+" and "-", you can choose the desired voltage.
10. Holding down the "L" or "S" button for some seconds, will allow you to memorize the current voltage respectively on the "liner" or "shader" position, so you may recall the values later on by simply pressing a button.
11. Holding down the "1", "2", "3", "4", "5" buttons for some seconds, you will memorize the current voltage, linking it to a specific machine frequently used at a predefined voltage. The very same operation can be manually done from the menu, through "Set Devices". By pressing "add", you can memorize the machine's name, the pre-set voltage and the position in the main screen buttons.
12. Pressing "L1" or "L2" in the lower part of main screen, you can change the output in use.

It's possible to download the control application on your own mobile phone from the Apple Store (Apple devices) or from the Play Store (Android devices). After installing it, you can run the control application. The picture below shows the main screen with the control buttons of the device.



- | | |
|-------------------------------|--------------------------------|
| a. Current Voltage; | h. Speed(in Hz); |
| b. Connect Bluetooth; | i. Duty cycle; |
| c. Increase voltage; | l. Working time; |
| d. Open the menu; | m. Remote Pedal; |
| e. Recall the "Liner" memory; | n. Recall the "Shader" memory; |
| f. Recall memories; | o. Decrease voltage; |
| g. Switch to "Line 1; | p. Switch to "Line2". |

External Power Supply

To avoid damaging the system we suggest using it only with the provided power supply, as it furnishes the correct supply to the iPower devices. An improper substitution of the power supply may cause the malfunctioning, the overheating and the damage of the entire system.

iPower Main Unit

The iPower device should be powered by the external regulator and controlled by the appropriate application. The two 1/4" audio jack outputs allow for two tattoo machines, even of different kind, to be connected at the same time.

The 1/4" audio jack input allows to connect an external pedal in case you don't want to use the output voltage interruption function provided by the mobile application.

The device is also provided with a USB port that can be used to recharge your mobile device or to power other devices, such as small LED lamps, with USB connectors

Certification

The iPower product is certified according to the CE directive and marked according to the directive &TTE,1999/5/EC.

Identification label

The device comes with an identification label, as shown in the following image.





DICHIARAZIONE DI CONFORMITA' CE

Costruttore: IPOWER TATTOO SRL

Indirizzo: via Filippo Argelati 10 20143 Milano (MI)

Dichiara qui di seguito, sotto la propria responsabilità, che il prodotto:

Regolatore di Tensione
P/N 770IPOWER

E' conforme ai requisiti essenziali specificati dalla Direttiva europea:

Direttiva 2004/108/CE:concernente il ravvicinamento delle legislazioni degli stati membri relative alla Compatibilità Elettromagnetica.....

E' conforme alle seguenti norme tecniche armonizzate:

EN 61000-6-3 Ed. 2007: Compatibilità Elettromagnetica
Parte 6-3: Norme generiche – Emissione per gli ambienti residenziali, commerciali.....

EN 61000-6-1 Ed. 2007: Compatibilità Elettromagnetica
Parte 6-1: Norme generiche – Immunità per gli ambienti residenziali, commerciali.....

Milano, 23/01/2015

IPOWER TATTOO SRL – via Filippo Argelati 10 20143 Milano (MI) - P.IVA: 07458240723 - e.mail info@ipowertattoo.com



Declaration of Conformity to FCC Rules



Manufacturer: IPOWER TATTOO SRL

Address: Via Filippo Argelati 10 20143 Milano (MI)

Hereby declares that the product:

TYPE: Voltage regulator
MOD. NUMBER: 770IPOWER

has been tested and found to comply with the limits for Class B digital devices, according to FCC Part 15, Subpart B, Section 15.109(a) .

Supplementary Statement:

This device complies with Part 15 of the FCC Rules. Operation is subject to the following two conditions: (1) this device may not cause harmful interference, and (2) this device must accept any interference received, including interference that may cause undesired operation.

Milano, 23/01/2015

A handwritten signature in black ink, appearing to read 'Filippo Argelati'.

Policy

Always follow the local rules regarding tattoo operations. It's the operator full responsibility to comply to the rules and guarantee a safe environment for the customers.

The manufacturer of the iPower devices has no liability whatsoever over damages to objects or people, nor over infections caused by tattoo operations. Negligence or improper use of the machine and all the components linked to the iPower devices, are under the complete responsibility of the user.

The manufacturer has no responsibility in case of contaminations or infections of man or animals.

Product

Handle the product carefully in order to keep it in good conditions.

The device should never be exposed to water or other fluids.

Such a contact could cause an irreparable damage of the device itself.

Do never connect external power supplies different from the provided one. Keep the product away from particularly hot or cold places.

Clients

iPower tattoo provides products for professional tattoo artists that must be aware of the risk of diseases that may be caused by a work environment that doesn't comply to the proper regulations, and by the use of non-sterile equipment.

Do always use:

- Sterile needles
- Latex Gloves
- Plastic bags covering the external power supply and the iPower device, to be changed after every use. Always keep the equipment clean and sterilized.

